

NOTES:

1. ALL SIGNS ARE TO BE INSTALLED IN ACCORDANCE WITH THE CURRENT VERSION OF THE MANUAL ON UNIFORM TRAFFIC CONTROL DEVICES FOR CONVENTIONAL ROADS.
2. OFF-SITE DETOUR SIGNS TO BE PROVIDED BY THE CONTRACTOR AND SHALL BE INCLUDED IN ITEM 619.01.
3. THE SIGN LOCATIONS SHOWN ON THE PLANS ARE APPROXIMATE. THE EXACT LOCATIONS SHALL BE DETERMINED BY THE ENGINEER.
4. THE MODIFICATION, RELOCATION OR ADJUSTMENT OF EXISTING SIGNS SHALL BE AS SHOWN ON PLANS OR AS DIRECTED BY THE ENGINEER, AND SHALL BE INCLUDED IN ITEM 619.01.
5. ALL SIGNS ARE TO BE PLACED WITHIN THE R.O.W.
6. SIGNS DIRECTING TRAFFIC TO USE THE SOUTH EXIT OF THE RT 19, CR 221, CR 281 ROUNDBOUT ARE TO BE COVERED FOR THE DURATION OF THE DETOUR. SIGNS ARE TO DIRECT TRAFFIC TO USE THE WEST EXIT OF THE ROUND ABOUT (CR 281)

LEGEND	
	TEMPORARY SIGN
	PVMS (SEE WZP1-6)
	TYPE III BARRICADE
	WORK AREA
	DETOUR SIGN ASSEMBLY (SEE WZP1-3, WZP1-6)

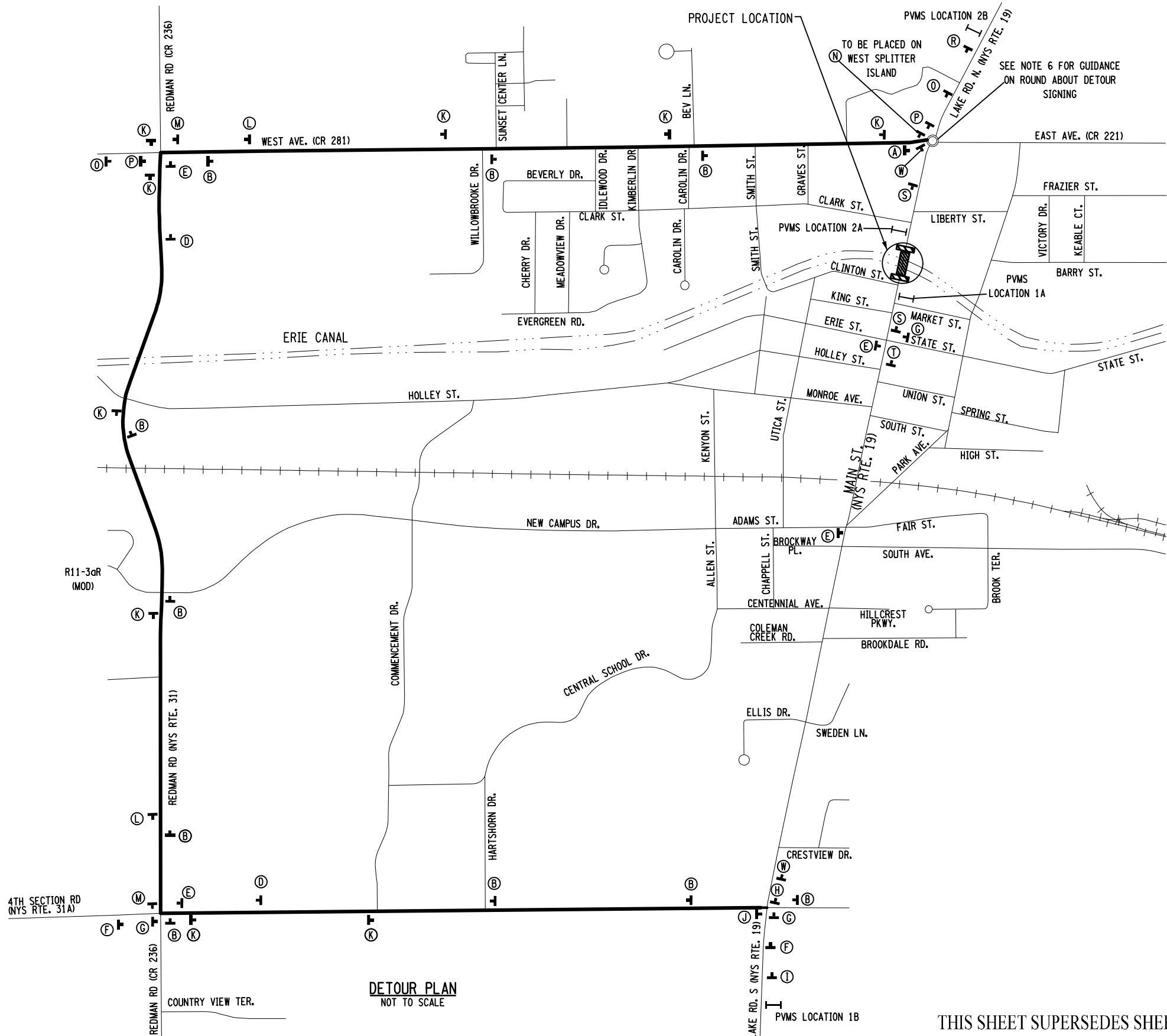

DETOUR PLAN
NOT TO SCALE

THIS SHEET SUPERSEDES SHEET 7

AFFIX SEAL: GERARD J. SENTZ, P.E.
 ON: OCTOBER 29, 2021
 ALTERED BY:
 ON:



AS-BUILT REVISIONS DESCRIPTION OF ALTERATIONS:	CANAL LIFT BRIDGE REHABILITATION	PIN 4940.X5	BRIDGES 4443240	ALL DIMENSIONS IN FT UNLESS OTHERWISE NOTED WORK ZONE TRAFFIC CONTROL - DETOUR PLAN ROUTE 19 OVER ERIE CANAL	CONTRACT NUMBER D264615 DRAWING NO. WZP1-2 SHEET NO. 7A1
	ROUTE 19 OVER ERIE CANAL, VILLAGE OF BROCKPORT	DATE OCTOBER 2021	CULVERTS		
	ROUTE 98 OVER ERIE CANAL, VILLAGE OF ALBION				
	TOWNS OF SWEDEN, ALBION				
	COUNTY: MONROE COUNTY, ORLEANS COUNTY	REGION: 4			

IT IS A VIOLATION OF LAW FOR ANY PERSON, UNLESS THEY ARE ACTING UNDER THE DIRECTION OF A LICENSED PROFESSIONAL ENGINEER, ARCHITECT, LANDSCAPE ARCHITECT, OR LAND SURVEYOR, TO ALTER AN ITEM IN ANY WAY. IF AN ITEM BEARING THE STAMP OF A LICENSED PROFESSIONAL IS ALTERED, THE ALTERING ENGINEER, ARCHITECT, LANDSCAPE ARCHITECT, OR LAND SURVEYOR SHALL STAMP THE DOCUMENT AND INCLUDE THE NOTATION "ALTERED BY" FOLLOWED BY THEIR SIGNATURE, THE DATE OF SUCH ALTERATION, AND A SPECIFIC DESCRIPTION OF THE ALTERATION.

DETOUR SIGN KEY
FOR USE ON WZP1-2

(A) END DETOUR M4-8A, NORTH M3-1, 19 NYM3-1

(B) DETOUR M4-8, NORTH M3-1, 19 NYM3-1, ↑ M6-3

(C) DETOUR M4-8, NORTH M3-1, 19 NYM3-1, ↖ M6-2L

(D) DETOUR M4-8, NORTH M3-1, 19 NYM3-1, ↗ M5-1R

(E) DETOUR M4-8, NORTH M3-1, 19 NYM3-1, → M6-1R

(F) DETOUR M4-8, NORTH M3-1, 19 NYM3-1, ↙ M5-1L

(G) DETOUR M4-8, NORTH M3-1, 19 NYM3-1, ← M6-1L

(H) VILLAGE BUSINESSES OPEN S-2 (SPECIAL) 4' X 3'-3"

(I) DETOUR SOUTH M3-3, 19 NYM3-1, ↑ M6-3

(J) END DETOUR M4-8A, SOUTH M3-3, 19 NYM3-1, ↗ M6-2R

(K) DETOUR SOUTH M3-3, 19 NYM3-1, ↑ M6-3

(L) DETOUR SOUTH M3-3, 19 NYM3-1, ↙ M5-1L

(M) DETOUR SOUTH M3-3, 19 NYM3-1, ← M6-1L

(N) DETOUR SOUTH M3-3, 19 NYM3-1, ↗ M6-2R

(O) DETOUR SOUTH M3-3, 19 NYM3-1, ↗ M5-1R

(P) DETOUR SOUTH M3-3, 19 NYM3-1, → M6-1R

(Q) ROAD CLOSED 500 FT W20-3RF (MOD.)

(R) ROAD CLOSED 1000 FT W20-3RF (MOD.)

(S) DETOUR 1500 FT W20-2 NOTE 6

(T) DETOUR 1500 FT W20-2 NOTE 6

(U) DETOUR 1500 FT W20-2 NOTE 6

NOTES:

- ALL SIGNS ARE TO BE INSTALLED IN ACCORDANCE WITH THE CURRENT VERSION OF THE MANUAL ON UNIFORM TRAFFIC CONTROL DEVICES FOR CONVENTIONAL ROADS.
- OFF-SITE DETOUR SIGNS TO BE PROVIDED BY THE CONTRACTOR AND SHALL BE INCLUDED IN ITEM 619.01.
- THE SIGN LOCATIONS SHOWN ON THE PLANS ARE APPROXIMATE. THE EXACT LOCATIONS SHALL BE DETERMINED BY THE ENGINEER.
- THE MODIFICATION, RELOCATION OR ADJUSTMENT OF EXISTING SIGNS SHALL BE AS SHOWN ON PLANS OR AS DIRECTED BY THE ENGINEER, AND SHALL BE INCLUDED IN ITEM 619.01.
- ALL SIGNS ARE TO BE PLACED WITHIN THE R.O.W.
- SIGNS DIRECTING TRAFFIC TO USE THE SOUTH EXIT OF THE RT 19, CR 221, CR 281 ROUNDABOUT ARE TO BE COVERED FOR THE DURATION OF THE DETOUR. SIGNS ARE TO DIRECT TRAFFIC TO USE THE WEST EXIT OF THE ROUND ABOUT (CR 281)

Q SIGN DESIGNATION NOT USED

U SIGN DESIGNATION NOT USED

V SIGN DESIGNATION NOT USED

W SHOWN ON WZP1-6

AFFIX SEAL: GERARD J. SENTZ, P.E.
ON: OCTOBER 29, 2021

ALTERED BY:
ON:



AS-BUILT REVISIONS DESCRIPTION OF ALTERATIONS:	CANAL LIFT BRIDGE REHABILITATION	PIN 4940.X5	BRIDGES 4443240	CULVERTS	ALL DIMENSIONS IN FT UNLESS OTHERWISE NOTED	CONTRACT NUMBER D264615
	ROUTE 19 OVER ERIE CANAL, VILLAGE OF BROCKPORT	DATE OCTOBER 2021				WZTC - DETOUR SIGN LEGEND
	ROUTE 98 OVER ERIE CANAL, VILLAGE OF ALBION				ROUTE 19 OVER ERIE CANAL	SHEET NO. 8A1
	TOWNS OF SWEDEN, ALBION					
	COUNTY: MONROE COUNTY, ORLEANS COUNTY	REGION: 4				

IT IS A VIOLATION OF LAW FOR ANY PERSON, UNLESS THEY ARE ACTING UNDER THE DIRECTION OF A LICENSED PROFESSIONAL ENGINEER, ARCHITECT, LANDSCAPE ARCHITECT, OR LAND SURVEYOR, TO ALTER AN ITEM IN ANY WAY. IF AN ITEM BEARING THE STAMP OF A LICENSED PROFESSIONAL IS ALTERED, THE ALTERING ENGINEER, ARCHITECT, LANDSCAPE ARCHITECT, OR LAND SURVEYOR SHALL STAMP THE DOCUMENT AND INCLUDE THE NOTATION "ALTERED BY" FOLLOWED BY THEIR SIGNATURE, THE DATE OF SUCH ALTERATION, AND A SPECIFIC DESCRIPTION OF THE ALTERATION.

THIS SHEET SUPERSEDES SHEET 8

FILE NAME = 4940X5_cph_01_mpp_03.dgn
 DATE/TIME = 01-NOV-2021 15:52
 USER = acouche

PROJECT MANAGER Q.P. JOHNSON
 CHECK A.J. COUCHE
 DRAFTING P.R. DIX
 CHECK G.J. SENTZ
 DESIGN A.J. COUCHE
 JOB MANAGER Q.P. JOHNSON
 DESIGN SUPERVISOR G.J. SENTZ

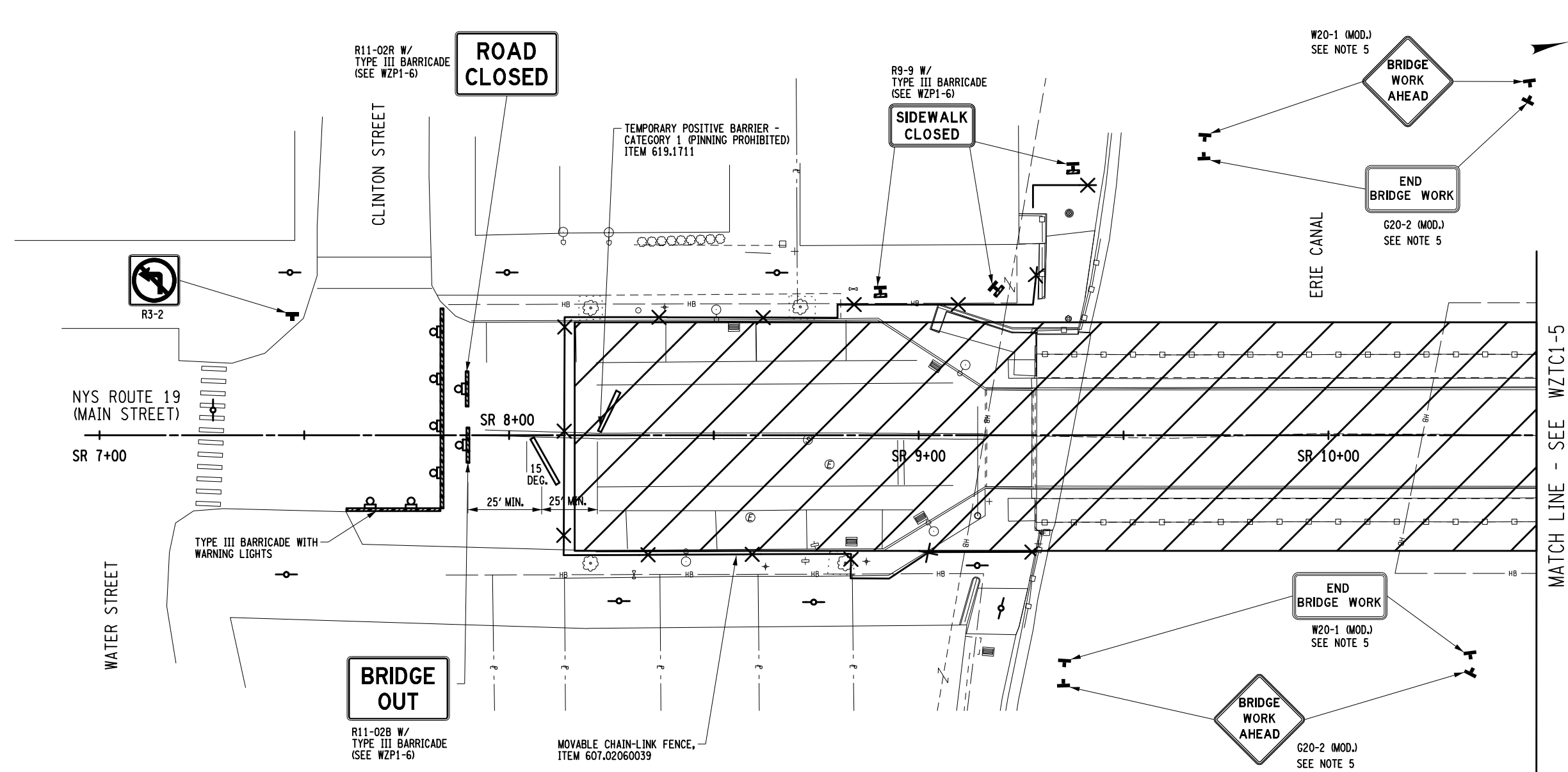

NOTES:

1. PEDESTRIAN ACCESS SHALL BE MAINTAINED AT ALL TIMES WHERE SHOWN ON THE PLAN, INCLUDING ACCESS TO ALL BUSINESSES. PEDESTRIAN AND BICYCLIST ACCESS TO THE ERIE CANAL TRAIL WITH A MIN. 5 FT WIDTH MUST BE MAINTAINED AT ALL TIMES.
2. ALL SIGN SIZES SHALL BE AS SPECIFIED BY NYS DOT STANDARD SHEET 619-12 FOR CONVENTIONAL ROAD UNLESS SPECIFIED OTHERWISE.
3. SIGN LOCATIONS SHOWN ON THE PLANS ARE APPROXIMATE. THE FINAL LOCATION OF THE SIGNS ARE SUBJECT TO APPROVAL BY THE ENGINEER.
4. THE TYPE III BARRIERS AND THE MOVABLE CHAIN-LINK FENCE SHALL BE MAINTAINED AT ALL TIMES TO PROHIBIT UNAUTHORIZED ACCESS WITHIN THE ROADWAY CLOSURE AREA.
5. BRIDGE WORK AHEAD SIGN (W20-1 MOD.) AND END BRIDGE WORK (G20-2 MOD.) TO BE PLACED ALONG CANAL FOR BOAT TRAFFIC AT A LOCATION TO BE DETERMINED BY THE ENGINEER.
6. THE CONTRACTOR SHALL NOT USE MUNICIPAL PARKING SPACES.

LEGEND

- TEMPORARY SIGN INCLUDED IN ITEM 619.01
- TYPE III BARRICADE ITEM 619.04
- WORK AREA
- PEDESTRIAN ACCESS
- MOVABLE CHAIN-LINK FENCE ITEM 607.02060039
- TEMPORARY POSITIVE BARRIER - CATEGORY 1 (PINNING PROHIBITED) ITEM 619.1711

AFFIX SEAL: GERARD J. SENTZ, P.E.
 ON: OCTOBER 29, 2021

ALTERED BY:
 ON:



AS-BUILT REVISIONS DESCRIPTION OF ALTERATIONS:	CANAL LIFT BRIDGE REHABILITATION	PIN 4940.X5	BRIDGES 4443240	ALL DIMENSIONS IN FT UNLESS OTHERWISE NOTED WZTC BRIDGE CLOSURE SOUTH	CONTRACT NUMBER D264615
	ROUTE 19 OVER ERIE CANAL, VILLAGE OF BROCKPORT	DATE OCTOBER 2021			DRAWING NO. WZP1-4
	ROUTE 98 OVER ERIE CANAL, VILLAGE OF ALBION				SHEET NO. 9A1
	TOWNS OF SWEDEN, ALBION			ROUTE 19 OVER ERIE CANAL	
	COUNTY: MONROE COUNTY, ORLEANS COUNTY REGION: 4				

IT IS A VIOLATION OF LAW FOR ANY PERSON, UNLESS THEY ARE ACTING UNDER THE DIRECTION OF A LICENSED PROFESSIONAL ENGINEER, ARCHITECT, LANDSCAPE ARCHITECT, OR LAND SURVEYOR, TO ALTER AN ITEM IN ANY WAY. IF AN ITEM BEARING THE STAMP OF A LICENSED PROFESSIONAL IS ALTERED, THE ALTERING ENGINEER, ARCHITECT, LANDSCAPE ARCHITECT, OR LAND SURVEYOR SHALL STAMP THE DOCUMENT AND INCLUDE THE NOTATION "ALTERED BY" FOLLOWED BY THEIR SIGNATURE, THE DATE OF SUCH ALTERATION, AND A SPECIFIC DESCRIPTION OF THE ALTERATION.

THIS SHEET SUPERSEDES SHEET 9

MATCH LINE - SEE WZTC1-5

FILE NAME = 4940X5_cph_01_mpp_04.dgn
 DATE/TIME = 01-NOV-2021 15:52
 USER = acouche

PROJECT MANAGER Q.P. JOHNSON
 CHECK A.J. COUCHE
 DRAFTING P.R. DIX
 CHECK G.J. SENTZ
 DESIGN A.J. COUCHE
 JOB MANAGER Q.P. JOHNSON
 DESIGN SUPERVISOR G.J. SENTZ

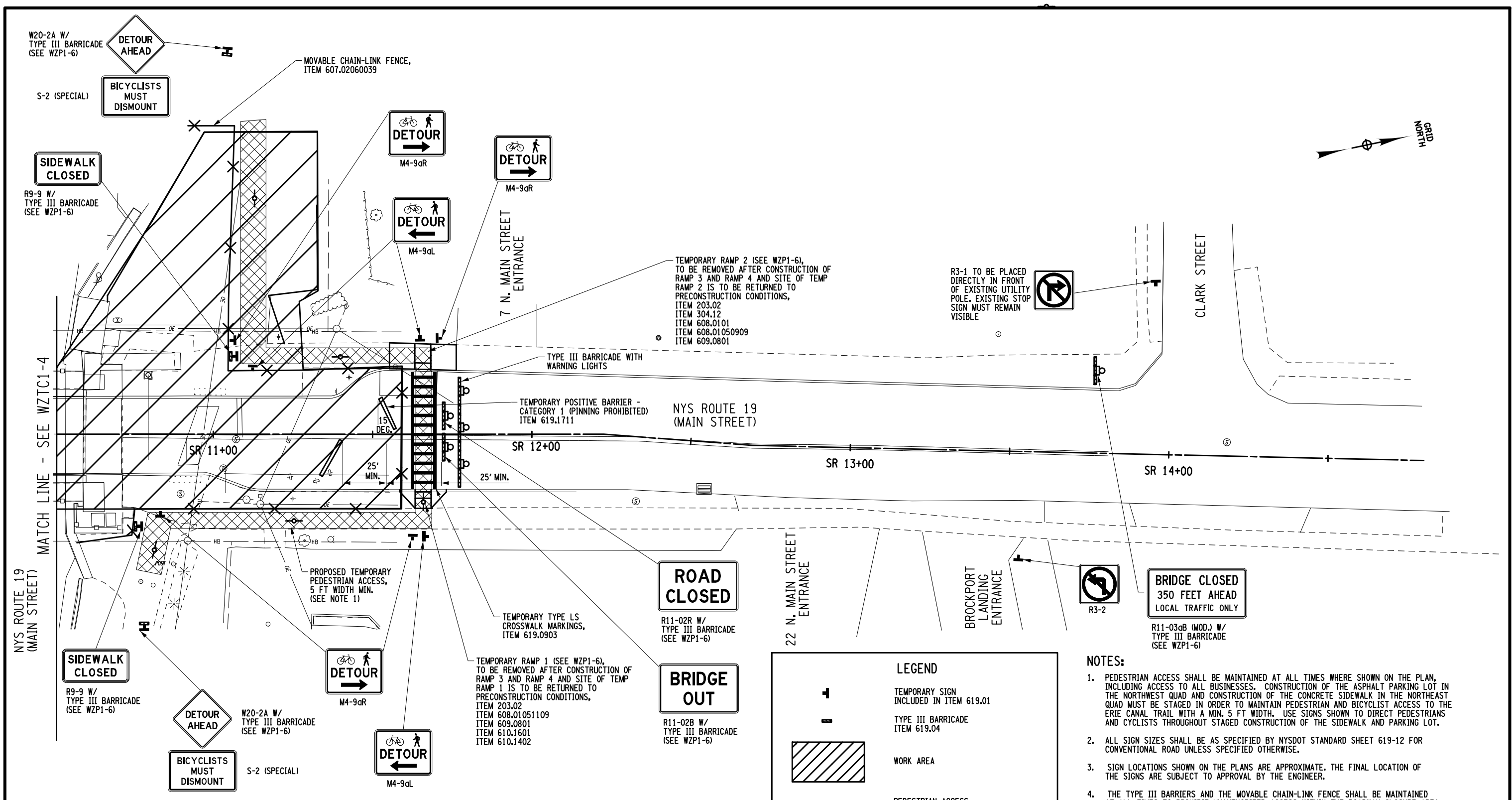

AFFIX SEAL: GERARD J. SENTZ, P.E.
 ON: OCTOBER 29, 2021

ALTERED BY:
 ON:

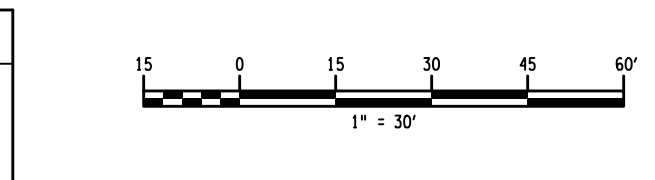

LEGEND

- TEMPORARY SIGN INCLUDED IN ITEM 619.01
- TYPE III BARRICADE ITEM 619.04
- WORK AREA
- PEDESTRIAN ACCESS
- MOVABLE CHAIN-LINK FENCE ITEM 607.02060039
- TEMPORARY POSITIVE BARRIER - CATEGORY 1 (PINNING PROHIBITED) ITEM 619.1711

- NOTES:**
- PEDESTRIAN ACCESS SHALL BE MAINTAINED AT ALL TIMES WHERE SHOWN ON THE PLAN, INCLUDING ACCESS TO ALL BUSINESSES. CONSTRUCTION OF THE ASPHALT PARKING LOT IN THE NORTHWEST QUAD AND CONSTRUCTION OF THE CONCRETE SIDEWALK IN THE NORTHEAST QUAD MUST BE STAGED IN ORDER TO MAINTAIN PEDESTRIAN AND BICYCLIST ACCESS TO THE ERIE CANAL TRAIL WITH A MIN. 5 FT WIDTH. USE SIGNS SHOWN TO DIRECT PEDESTRIANS AND CYCLISTS THROUGHOUT STAGED CONSTRUCTION OF THE SIDEWALK AND PARKING LOT.
 - ALL SIGN SIZES SHALL BE AS SPECIFIED BY NYS DOT STANDARD SHEET 619-12 FOR CONVENTIONAL ROAD UNLESS SPECIFIED OTHERWISE.
 - SIGN LOCATIONS SHOWN ON THE PLANS ARE APPROXIMATE. THE FINAL LOCATION OF THE SIGNS ARE SUBJECT TO APPROVAL BY THE ENGINEER.
 - THE TYPE III BARRIERS AND THE MOVABLE CHAIN-LINK FENCE SHALL BE MAINTAINED AT ALL TIMES TO PROHIBIT UNAUTHORIZED ACCESS WITHIN THE ROADWAY CLOSURE AREA.
 - BRIDGE WORK AHEAD SIGN (W20-1 MOD.) AND END BRIDGE WORK (G20-2 MOD.) TO BE PLACED ALONG CANAL FOR BOAT TRAFFIC AT A LOCATION TO BE DETERMINED BY THE ENGINEER.
 - THE CONTRACTOR SHALL NOT USE MUNICIPAL PARKING SPACES.
- THIS SHEET SUPERSEDES SHEET 10**

AS-BUILT REVISIONS DESCRIPTION OF ALTERATIONS:	CANAL LIFT BRIDGE REHABILITATION ROUTE 19 OVER ERIE CANAL, VILLAGE OF BROCKPORT ROUTE 98 OVER ERIE CANAL, VILLAGE OF ALBION TOWNS OF SWEDEN, ALBION COUNTY: MONROE COUNTY, ORLEANS COUNTY REGION: 4	PIN 4940.X5 DATE OCTOBER 2021	BRIDGES 4443240	CULVERTS	ALL DIMENSIONS IN FT UNLESS OTHERWISE NOTED WZTC BRIDGE CLOSURE NORTH ROUTE 19 OVER ERIE CANAL	CONTRACT NUMBER D264615 DRAWING NO. WZP1-5 SHEET NO. 10A1
IT IS A VIOLATION OF LAW FOR ANY PERSON, UNLESS THEY ARE ACTING UNDER THE DIRECTION OF A LICENSED PROFESSIONAL ENGINEER, ARCHITECT, LANDSCAPE ARCHITECT, OR LAND SURVEYOR, TO ALTER AN ITEM IN ANY WAY. IF AN ITEM BEARING THE STAMP OF A LICENSED PROFESSIONAL IS ALTERED, THE ALTERING ENGINEER, ARCHITECT, LANDSCAPE ARCHITECT, OR LAND SURVEYOR SHALL STAMP THE DOCUMENT AND INCLUDE THE NOTATION "ALTERED BY" FOLLOWED BY THEIR SIGNATURE, THE DATE OF SUCH ALTERATION, AND A SPECIFIC DESCRIPTION OF THE ALTERATION.						

PROJECT MANAGER Q.P. JOHNSON
 CHECK A.J. COUCHE
 DRAFTING P.R. DIX
 CHECK G.J. SENTZ
 DESIGN A.J. COUCHE
 JOB MANAGER Q.P. JOHNSON
 DESIGN SUPERVISOR G.J. SENTZ

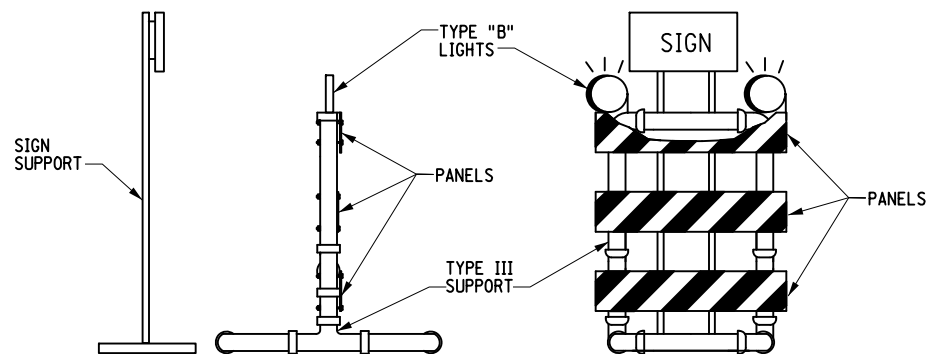

ITEM 619.04
 TYPE III CONSTRUCTION BARRICADE
 AND TYPE III CONSTRUCTION BARRICADE
 WITH SIGN
 NOT TO SCALE

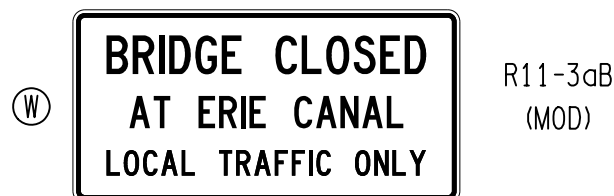

ROAD CLOSED SIGN DESIGNATION
 FOR USE ON WZP1-2,
 TO BE POSTED BEHIND TYPE III
 CONSTRUCTION BARRICADE AS SHOWN
 IN ITEM 619.04 DETAIL
 NOT TO SCALE

LOCATION 1A AND 2A

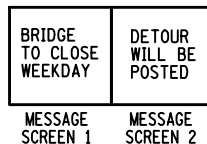

ADVANCED SIGNS
 (FOR ONE WEEK PRIOR TO DETOUR)

LOCATION 1B AND 2B

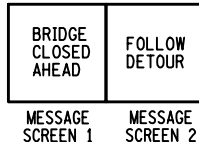

SIGNS TO BE PLACED PRIOR
 TO DETOUR AND TO REMAIN IN
 PLACE FOR FIRST WEEK OF DETOUR

ITEM 619.111111
 PORTABLE VARIABLE MESSAGE SIGNS (PVMS)
 NOT TO SCALE

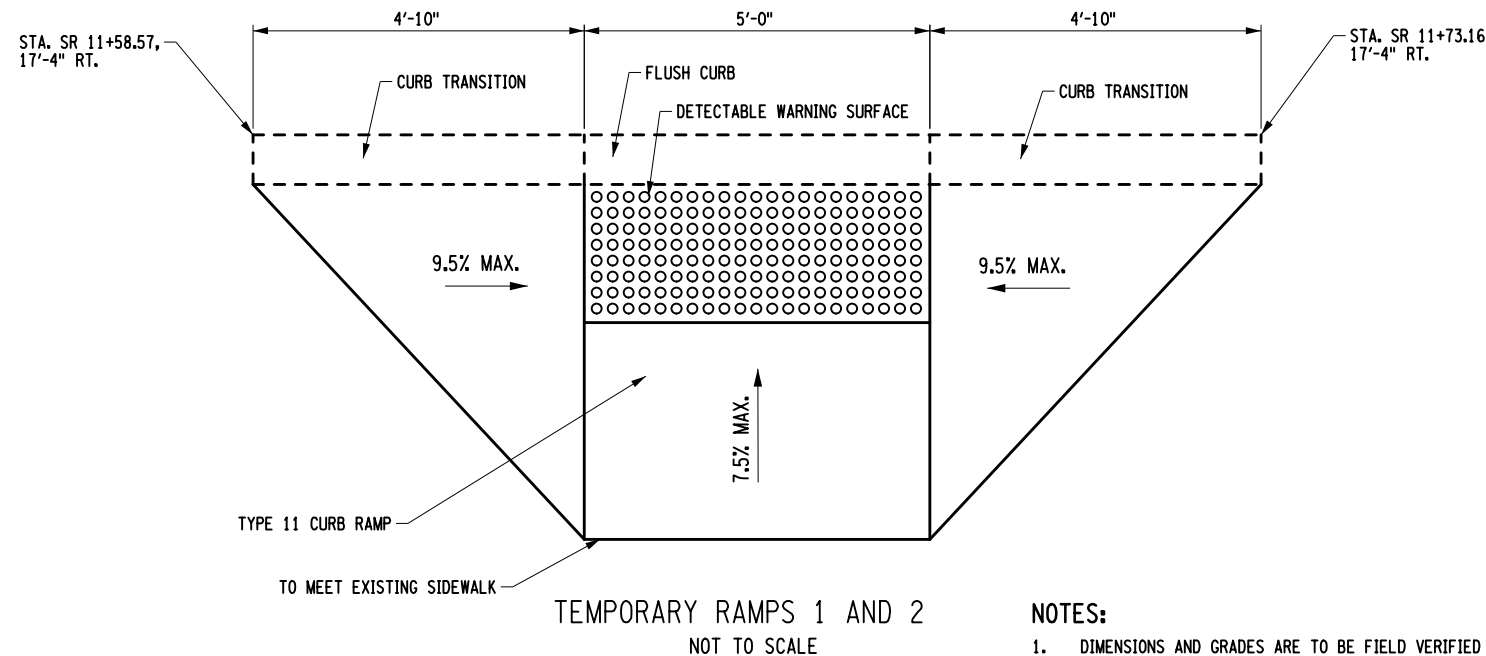
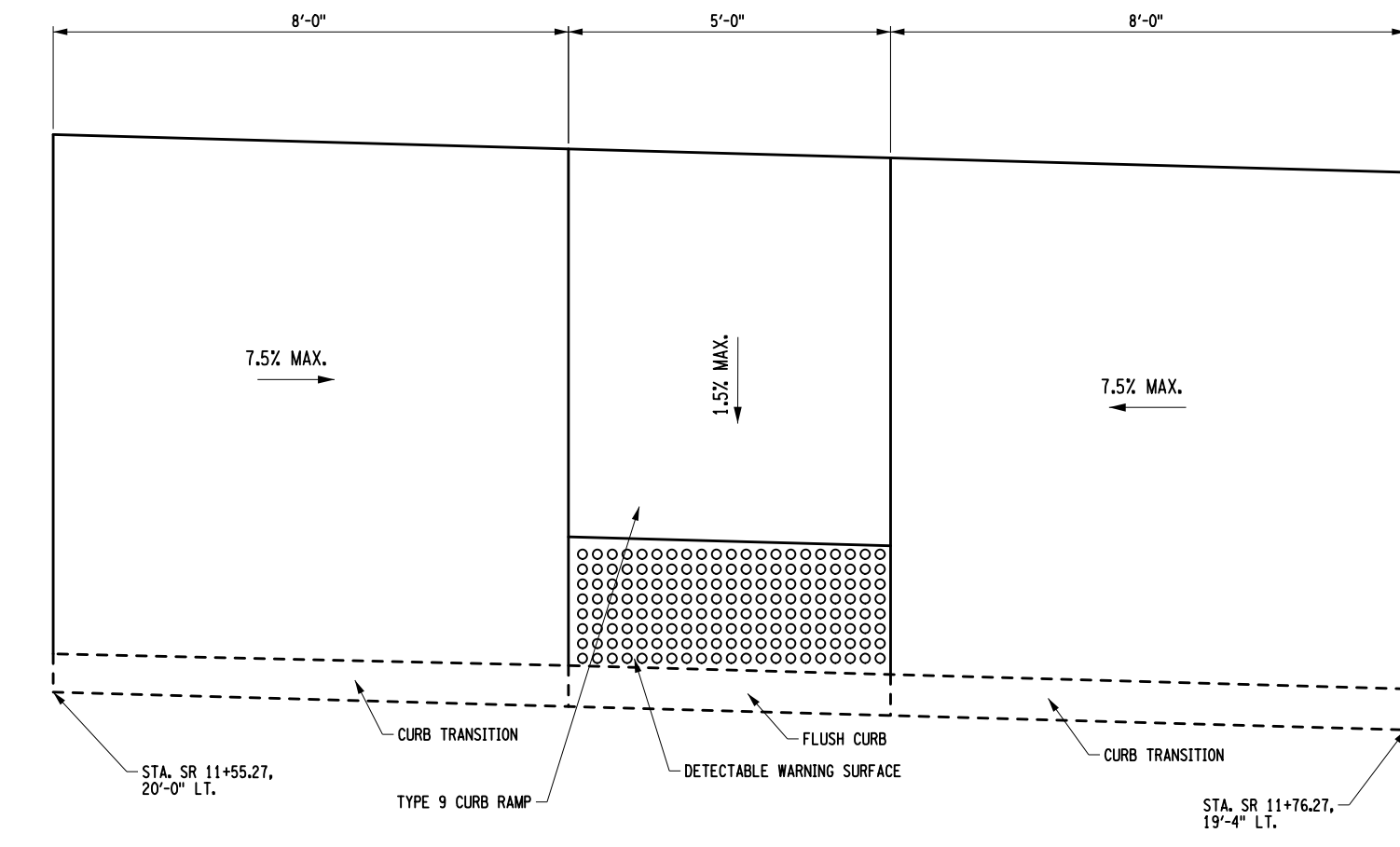

TEMPORARY RAMPS 1 AND 2
 NOT TO SCALE

NOTES:
 1. DIMENSIONS AND GRADES ARE TO BE FIELD VERIFIED PRIOR TO CONSTRUCTION OF THE TEMPORARY CURB RAMPS.

AFFIX SEAL: GERARD J. SENTZ, P.E.
 ON: SEPTEMBER 24, 2021
 ALTERED BY:
 ON:



AS-BUILT REVISIONS DESCRIPTION OF ALTERATIONS:	CANAL LIFT BRIDGE REHABILITATION	PIN 4940.X5	BRIDGES 4443240	CULVERTS	ALL DIMENSIONS IN FT UNLESS OTHERWISE NOTED	CONTRACT NUMBER D264615
	ROUTE 19 OVER ERIE CANAL, VILLAGE OF BROCKPORT	DATE SEPTEMBER 2021				WORK ZONE TRAFFIC CONTROL - DETAILS
	ROUTE 98 OVER ERIE CANAL, VILLAGE OF ALBION					SHEET NO. 11
	TOWNS OF SWEDEN, ALBION					
	COUNTY: MONROE COUNTY, ORLEANS COUNTY	REGION: 4			ROUTE 19 OVER ERIE CANAL	

IT IS A VIOLATION OF LAW FOR ANY PERSON, UNLESS THEY ARE ACTING UNDER THE DIRECTION OF A LICENSED PROFESSIONAL ENGINEER, ARCHITECT, LANDSCAPE ARCHITECT, OR LAND SURVEYOR, TO ALTER AN ITEM IN ANY WAY. IF AN ITEM BEARING THE STAMP OF A LICENSED PROFESSIONAL IS ALTERED, THE ALTERING ENGINEER, ARCHITECT, LANDSCAPE ARCHITECT, OR LAND SURVEYOR SHALL STAMP THE DOCUMENT AND INCLUDE THE NOTATION "ALTERED BY" FOLLOWED BY THEIR SIGNATURE, THE DATE OF SUCH ALTERATION, AND A SPECIFIC DESCRIPTION OF THE ALTERATION.



FILE NAME = 4940X5_cph_01_mpd_01.dgn
 DATE/TIME = 01-OCT-2021 12:38
 USER = acouche